

**A NEW LOOK IN  
LUXURY: IT WILL  
MAKE YOU LOOK  
TWICE.**



**The New Hatteras  
48 Motor Yacht And  
52 Cockpit Motor  
Yacht.**

# There are other boats in this size The Hatteras 48 Motor Yacht and T



## Specifications

	48 Motor Yacht	
Length	48'9"	14.86 meters
Beam	16'0"	4.88 meters
Draft	4'8"	1.42 meters
Fuel	750 gallons	2840 liters
Water	170 gallons	645 liters

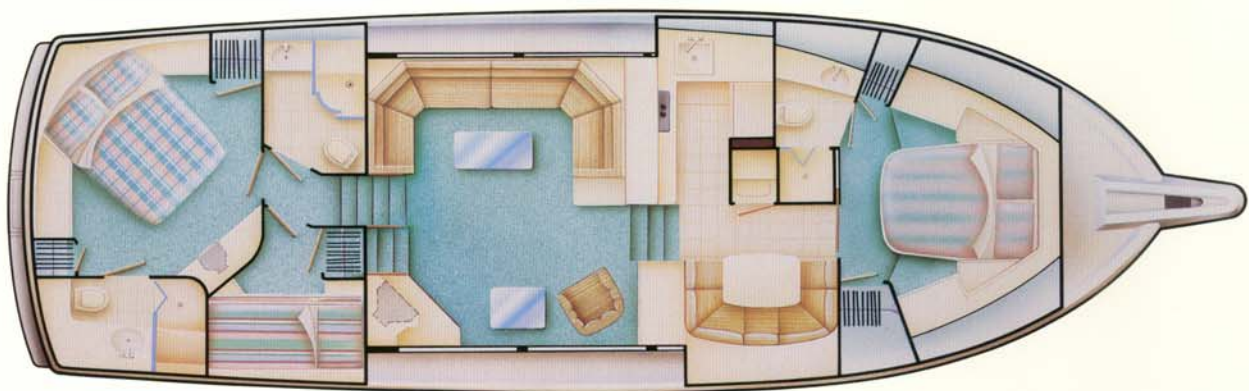

48 Motor Yacht

# range. But only two in this class: The Hatteras 52 Cockpit Motor Yacht.

## 48 Motor Yacht



Here's proof, once again, that for performance, styling, comfort and quality, the only thing that comes close to a Hatteras is another Hatteras.

The Hatteras 48MY and the Hatteras 52CMY both feature a new Hatteras-designed modified-V hull. The deep-V entry cuts through the seas . . . broadening out for a solid, stable ride.

Like most fiberglass boats, the entire superstructure of these Hatteras motor yachts are covered with a tough gelcoat finish. But then Hatteras goes even further, covering the gelcoat with a tough layer of Imron® polyurethane paint for added years of easier maintenance.

The flybridge is designed for excellent visibility, family comfort and easy access to controls and equipment. It features L-shaped bench seating to port, a two-place riding seat to starboard, helm and companion seats at the wrap-around helm, and a covered console for your electronics. (An optional lower control station is also available.)

Similar in interior layout to the 48MY, the 52CMY includes a generous cockpit for direct water access and dinghy handling, with a transom gate and swim platform.

Both include the option of a permanently-enclosed aft deck, available with air-conditioning and reverse-cycle heat, creating an extra living area. (The molded storage cabinet can even be converted to a wet bar.)

The main deck is one level, with side decks of a comfortable width for easy walking and deck access, wing doors, and full-height entry door into the salon.

Inside, Hatteras design and craftsmanship excellence are again obvious at a glance. The interior is available in the traditional Hatteras varnished mid-tone afromosia finish, or — at your option — a contemporary lighter wood-tone finish.

The mid-ship salon is totally luxurious, with a custom U-shaped lounge, beautifully upholstered; a wet bar with icemaker; and a built-in entertainment center, with TV and stereo system. And there's custom-designed lighting throughout.



52 Cockpit Motor Yacht

Down a few steps forward, the galley has been thoughtfully planned for life aboard, with spacious storage and work areas adjacent to a Frigidaire Euro-Flair stacked refrigerator/freezer. There's a 240-volt, 3-burner cooktop; a convection-microwave oven with vent fan; and a dinette seating four that can convert to a spare berth.

Below, a grand guest stateroom is forward, complete with a generous walk-around queen bed, twin hanging lockers, large storage drawers, and a private head with stall shower. (All bedding and linens are included, by the way, selected from Hatteras' own Decor groups.) There's a convenient washer/dryer, also standard equipment, in the companionway locker.

The second guest stateroom features full-size upper and lower berths, hanging locker, storage space and — just across the companionway — a guest/day head with molded countertops and a full-size stall shower with a curved sliding door.

Aft is the luxurious master stateroom. The queen-size bed is placed diagonally for walk-around comfort, and you'll find his and her hanging lockers, nightstands, built-in lighting, Hatteras quality cabinetry, a full-drawer storage unit with space above for a built-in TV, and a separate AM/FM stereo system.

Include the private head with large stall shower and the one-piece vanity, and you have a master stateroom nothing else can compare with.

Optionally, the second guest stateroom can be combined with the master stateroom in either model to create an exceptionally grand owner's area aft of the salon.

Everywhere you look are signs of Hatteras quality: the air-conditioning system that's custom-engineered for quiet, even air distribution . . . the latest in contemporary lighting . . . the refined cabinet construction . . . the thoughtful and thoroughly-engineered hull structure . . . a host of big-yacht systems . . . and the Hatteras-designed Systems Monitor to keep an eye on high-priority functions.

The Hatteras 48MY and 52CMY are powered with high performance, twin D.D. 6V-92TA diesels rated at 535 SHP, or optional D.D. 8V-92TA twins rated at 720 SHP for added muscle. A 20 kW generator is included.

The Hatteras 48MY and 52CMY: achievements that go beyond the state-of-the-art in computer technology and naval architecture, to create a whole new class of innovative luxury yachts. Can you think of a better reward for your achievements?



### Specifications

#### 52 Cockpit Motor Yacht

Length	52'9"	16.08 meters
Beam	16'0"	4.88 meters
Draft	4'5"	1.35 meters
Fuel	950 gallons	3600 liters
Water	170 gallons	645 liters

# Hatteras

Hatteras Yachts  
 2100 Kivett Drive  
 P.O. Box 2690  
 High Point, North Carolina 27261 U.S.A.  
 Telephone: (919) 889-6621